

HIGHWAY LANDSCAPE DEVELOPMENT PROJECT

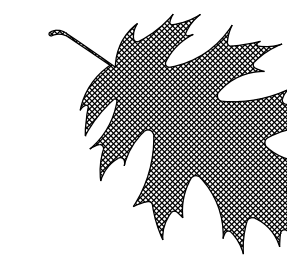

T.I.P. #	STATE PROJECT W.B.S. #	SHEET #	SHEET # TOTAL
R-2250	34411.1.2	L1	5
FED. PROJ. #	DESCRIPTION		DIVISION
-----	TIP		2

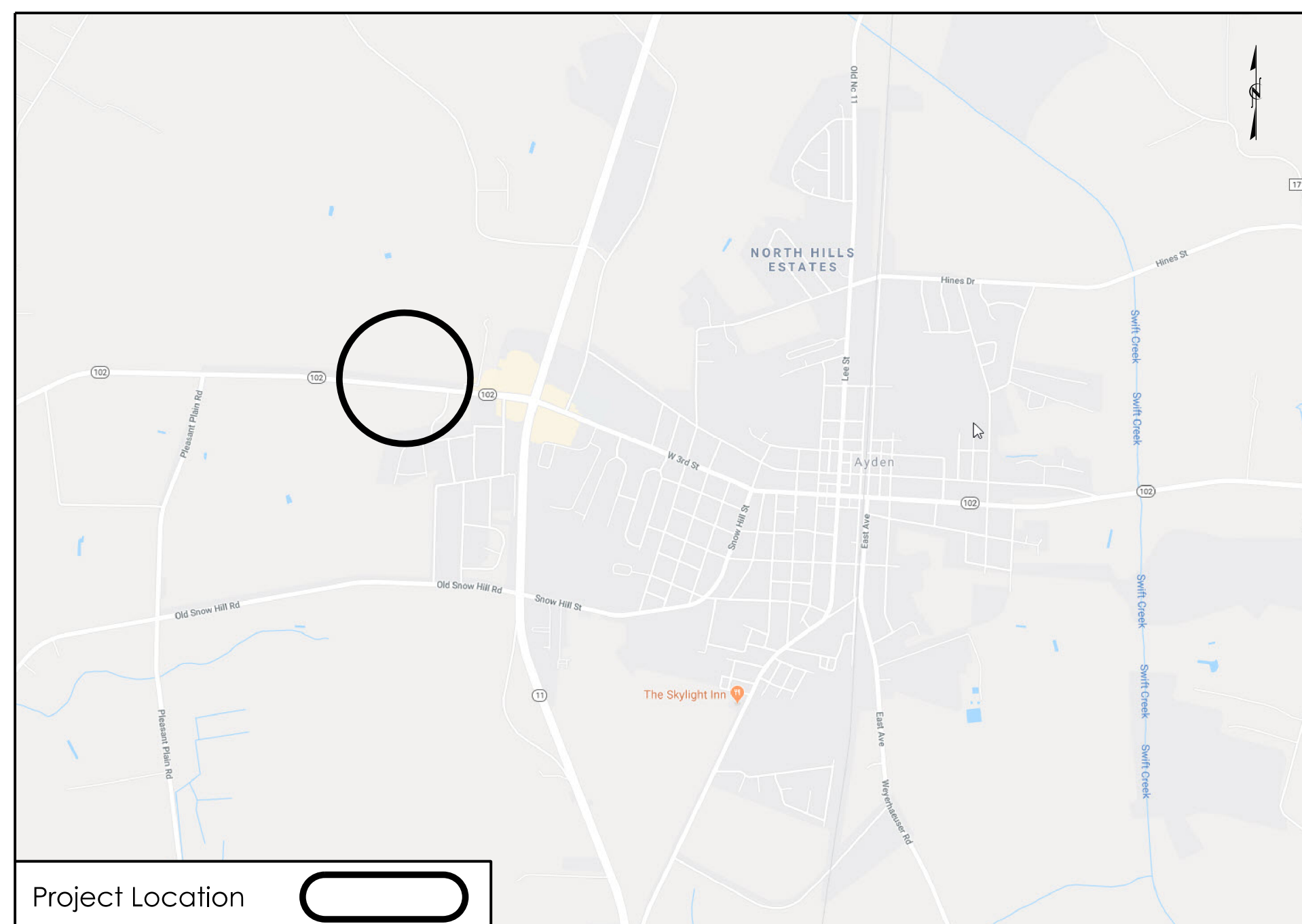

Summary of Quantities
1 Year Establishment

DES	SEC	QTY	UNIT	KEY	BOTANICAL NAME	COMMON NAME	SIZE	CALIPER	FURNISH	A.S.N.S.	REMARKS
Trees											
L	1670	9	ea	CV	<i>Chionanthus virginicus</i>	White Fringe Tree	6-7'		B&B	2.3	50' O.C.
L	1670	14	ea	JB	<i>Juniperus virginiana 'Burkii'</i>	Burk Eastern Red Cedar	6-7'		B&B	4.7	As Shown
L	1670	8	ea	LR	<i>Lagerstroemia indica 'Whit IV'</i>	Red Rocket Crape Myrtle	5-6'	1.5-2"	#25 Cont.	2.4	50' O.C.
Shrubs											
L	1670	42	ea	IB	<i>Ilex cornuta 'Dwarf Burford'</i>	Dwarf Burford Holly	18-24"		#3 Cont	5.7	5' O.C.
L	1670	44	ea	IC	<i>Ilex cornuta 'Carissa'</i>	Carissa Holly	18-24"		#3 Cont	5.7	3.5' O.C.
L	1670	42	ea	IG	<i>Ilex glabra</i>	Inkberry Holly	18-24"		#3 Cont	5.7	5' O.C.
L	1670	18	ea	RR	<i>Rosa 'Radtko'</i>	The Double Knock Out® Rose	18-24"		#3 Cont	6.1	4' O.C.
L	1670	6	ea	SV	<i>Spiraea x vanhouttei</i>	Vanhoutte Spirea	18-24"		#3 Cont	3.3	AS Shown
Grasses/Groundcovers/Perennials											
L	1670	96	ea	HS	<i>Hemerocallis 'Stella de Oro'</i>	Stella de Oro Daylily	6-12"		#1 Cont	13.2,3	2' O.C.
L	1670	196	ea	LM	<i>Liriope muscari 'Variegata'</i>	Variegated Lilyturf	6-12"		#SP4	13.5	16" O.C.
L	SP	285	sy	ZO	<i>Zoysia 'Zenith'</i>	Zenith® Zoysiagrass	n/a		Sod	n/a	Tight Seams
Other Vegetation Costs											
L	1670	12	ea		Monthly Maintenance						
L	1670	107.5	cy		Mulch for Planting						Depth of 4"
L	1670	975	sy		Pre emergence Herbicidal Treatment						
L	1670	975	sy		Post emergence Herbicidal Treatment						
L	1101	1	LS		Temporary Traffic Control						
L	1670	8	m/g		Water for Planting						
* Sod quantity shown in Summary of Quantities and Estimate includes 10% extra											

NOTES:

- Existing conditions shown on the plans are based on survey information and roadway plans. actual site conditions may vary.
- Prior to any demolition or work taking place, the contractor shall locate and verify all utility lines and structures within the construction areas (water, sewer, gas, electrical, etc.)
- The contractor shall take the necessary precautions to prevent damage of adjacent plant material, facilities, and structures to remain. The contractor shall restore disturbed areas to their original condition and to the satisfaction of the Division Roadside Environmental Engineer.
- The utilities shown on the plans are approximate locations. The contractor shall locate and protect in place all existing utilities before digging occurs and major construction begins.
- Demolition, removal, and disposal of items from the site must be completely in accordance with the law. The contractor is responsible for making a site visit to determine and verify all demolition requirements prior to bidding.
- The contractor shall verify all conditions and dimensions at the job site prior to construction, and if discrepancies are found, notify the Division Roadside Environmental Engineer for clarification.

R-2250 NC 102 and South Bypass in Ayden

CONVENTIONAL SYMBOLS

County Line.....	-----
City or Town Line.....	-----
Exist. Right of Way Line Marker.....	-----▲-----
Prop. Right of Way Line Marker (By Others).....	-----▲-----
Prop Right of Way Line Marker (By Contract).....	-----▲-----
Exist. Control of Access Line.....	-----○-----
Prop. Control of Access Line.....	-----○-----
Property Line.....	-----
Easement Line.....	-----
Slope Stake Line.....	-----
Exist. Fence.....	-----
Prop. Woven Wire Fence.....	-----
Prop. Chain Link Fence.....	-----
Exist. Road.....	-----
Prop. Road.....	-----
Guardrail.....	-----
Survey Line.....	-----
Denotes Line Equality.....	-----
Bridge.....	-----
Culvert.....	-----
Railroad.....	-----
Woods.....	-----
Exist. Telephone Pole.....	-----
Prop. Telephone Pole.....	-----
Tower Pole and Line.....	-----
Exist. Power Pole.....	-----
Prop. Power Pole.....	-----
Sanitary Sewer Line.....	-----
Water Line.....	-----
Gas Line.....	-----
Picnic Shelter.....	-----
Regeneration.....	-----
Reforestation.....	-----

INDEX OF L SHEETS:

- L 1.0 - Title Sheet
- L 2.0 - Planting Details
- L 3.0-L 5.0 - Planting Plans

PREPARED BY: K. Cooper DATE: 11/23/2020

REVISIONS

DATE	DESCRIPTION

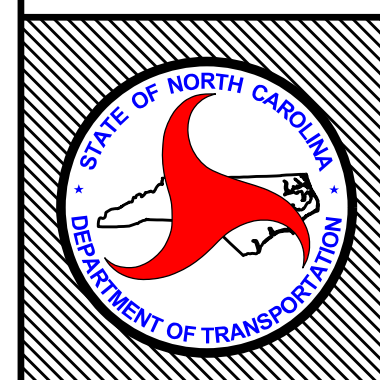

STATE OF
NORTH CAROLINA
DEPARTMENT OF TRANSPORTATION







LOCATION: NC 102 & South Bypass in Ayden

TYPE of WORK: TIP

COUNTY: Pitt County

2014 American Standard for Nursery Stock
2018 NCDOT STANDARD SPECIFICATIONS
PREPARED IN THE OFFICE OF:
NCDOT- ROADSIDE ENVIRONMENTAL UNIT
AESTHETIC ENGINEERING SECTION
1557 MAIL SERVICE CENTER
RALEIGH, NC 27699 919-707-2920

NOTES:

-  SCHEDULE FOR PLANT HOLE SIZE: PLANT HOLE WIDTH (X) TO BE TWICE THE ROOT BALL SIZE OR CONTAINER DIAMETER.
-  SEE STANDARD SPECIFICATIONS FOR PLANT BED FUMIGATION AND HERBICIDAL TREATMENT.
-  APPLY FERTILIZER AT PLANTING TIME IN THE FORM OF A SLOW RELEASE PELLET OR TABLET. APPLY AT RATE RECOMMENDED BY MANUFACTURER. BOTH RATE AND FORMULATION MUST BE APPROVED BY FIELD ENGINEER PRIOR TO APPLICATION.
-  REMOVE WIRE BASKET AND FOLD BURLAP BACK FROM TOP OF ROOT BALL BEFORE BACKFILLING IS COMPLETE.
-  ALL PRUNING TO FOLLOW STANDARD ARBORICULTURAL PRACTICES AS SPECIFIED BY INTERNATIONAL SOCIETY OF ARBORICULTURE.
-  DO NOT ATTEMPT TO STRAIGHTEN A TREE THAT HAS BEEN PLANTED AT AN ANGLE WITH THE USE OF STAKING OR GUYING. DIG TREE AND REPLANT TO UPRIGHT POSITION.

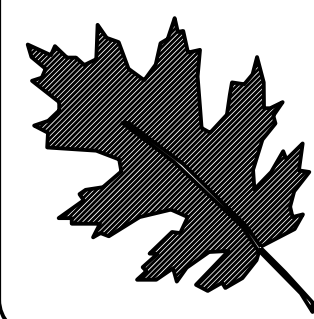
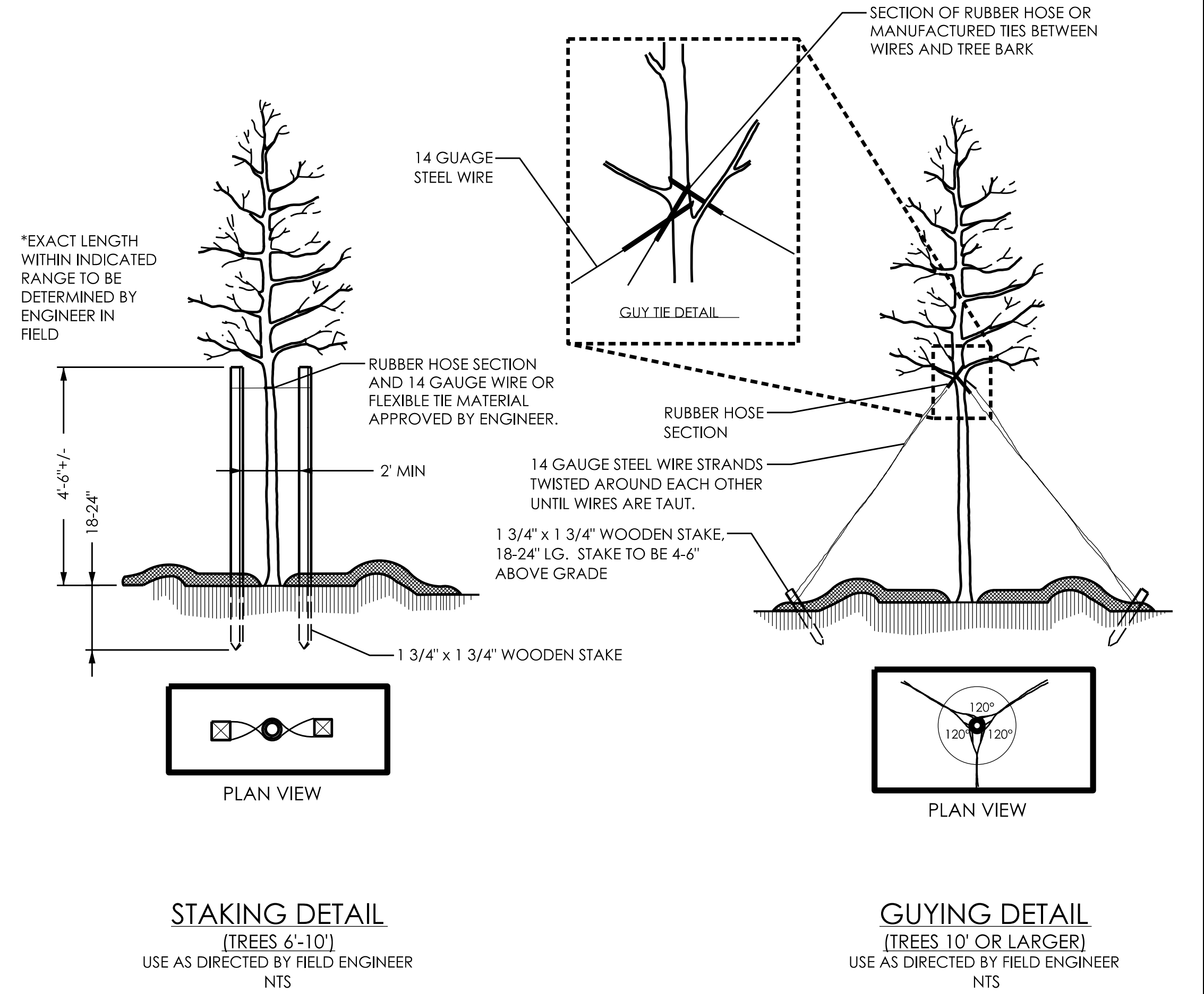
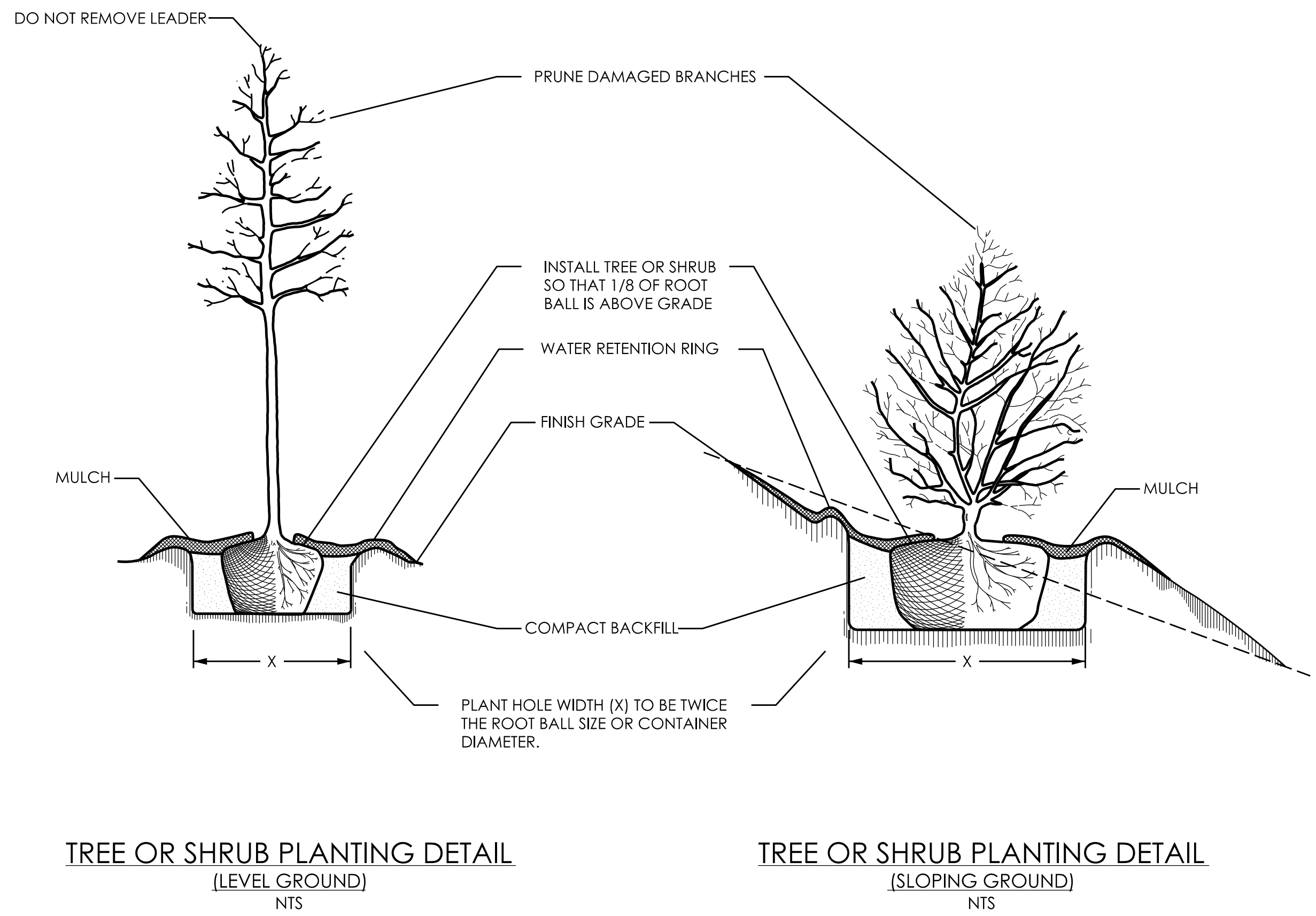
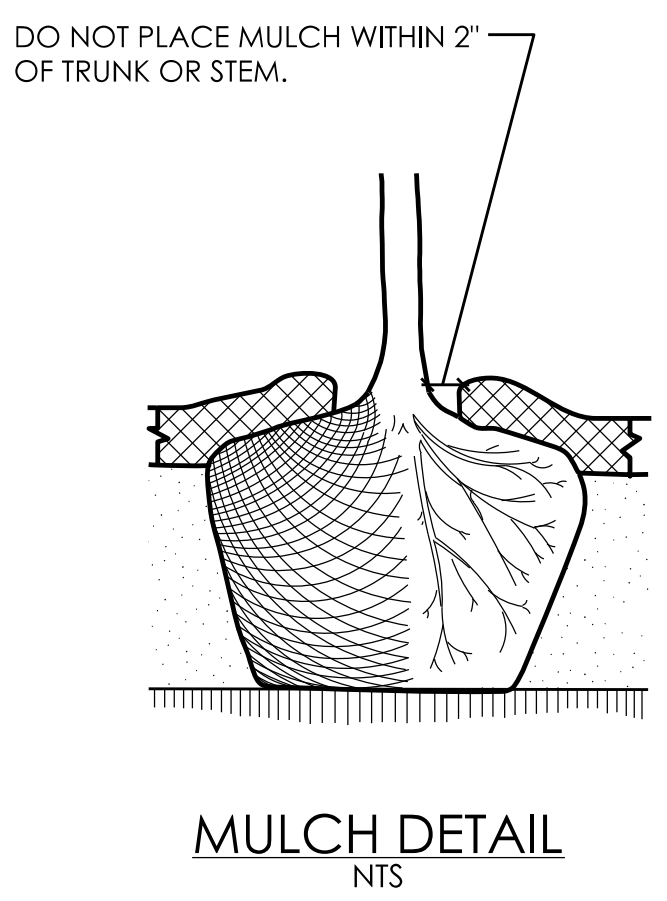
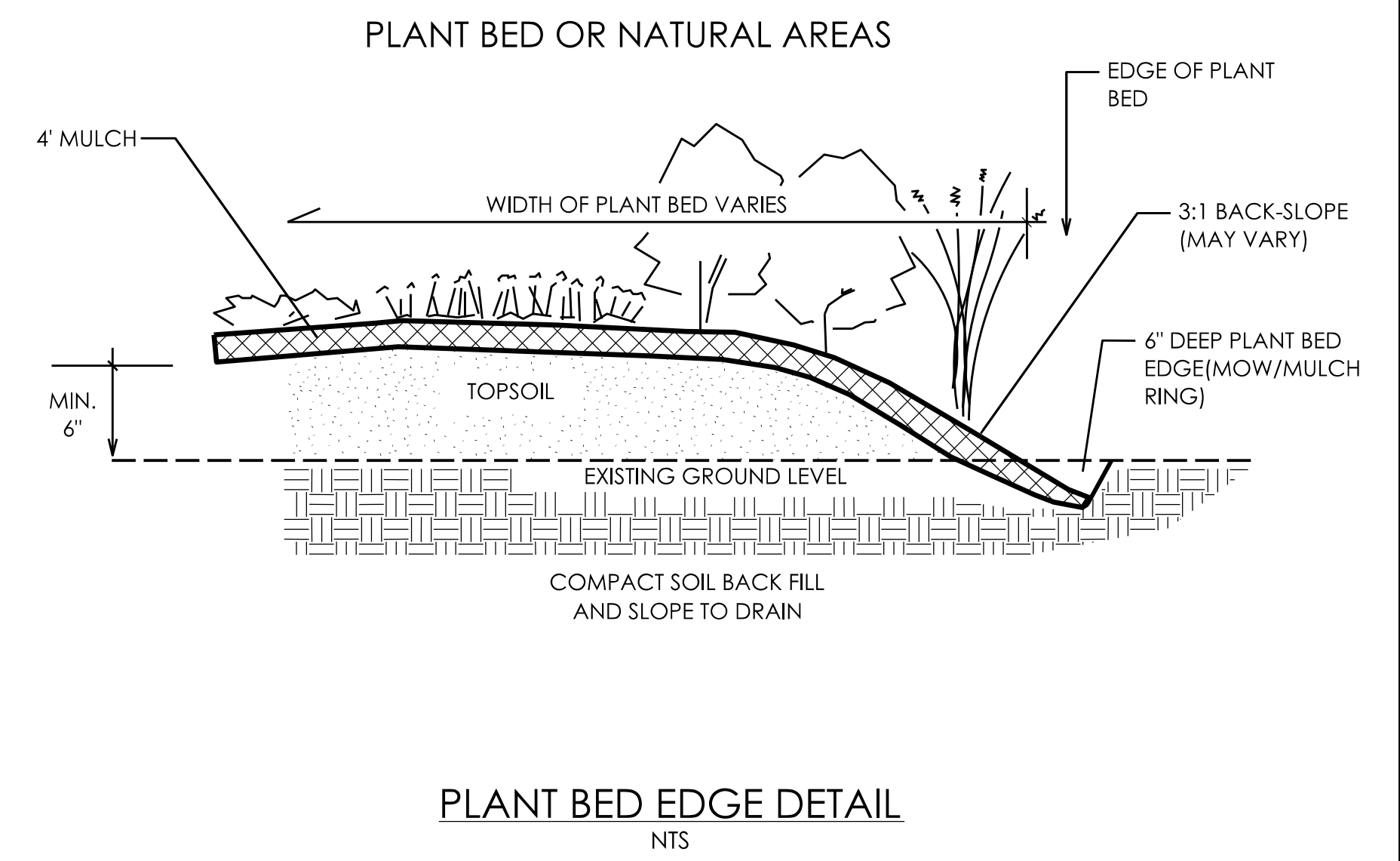
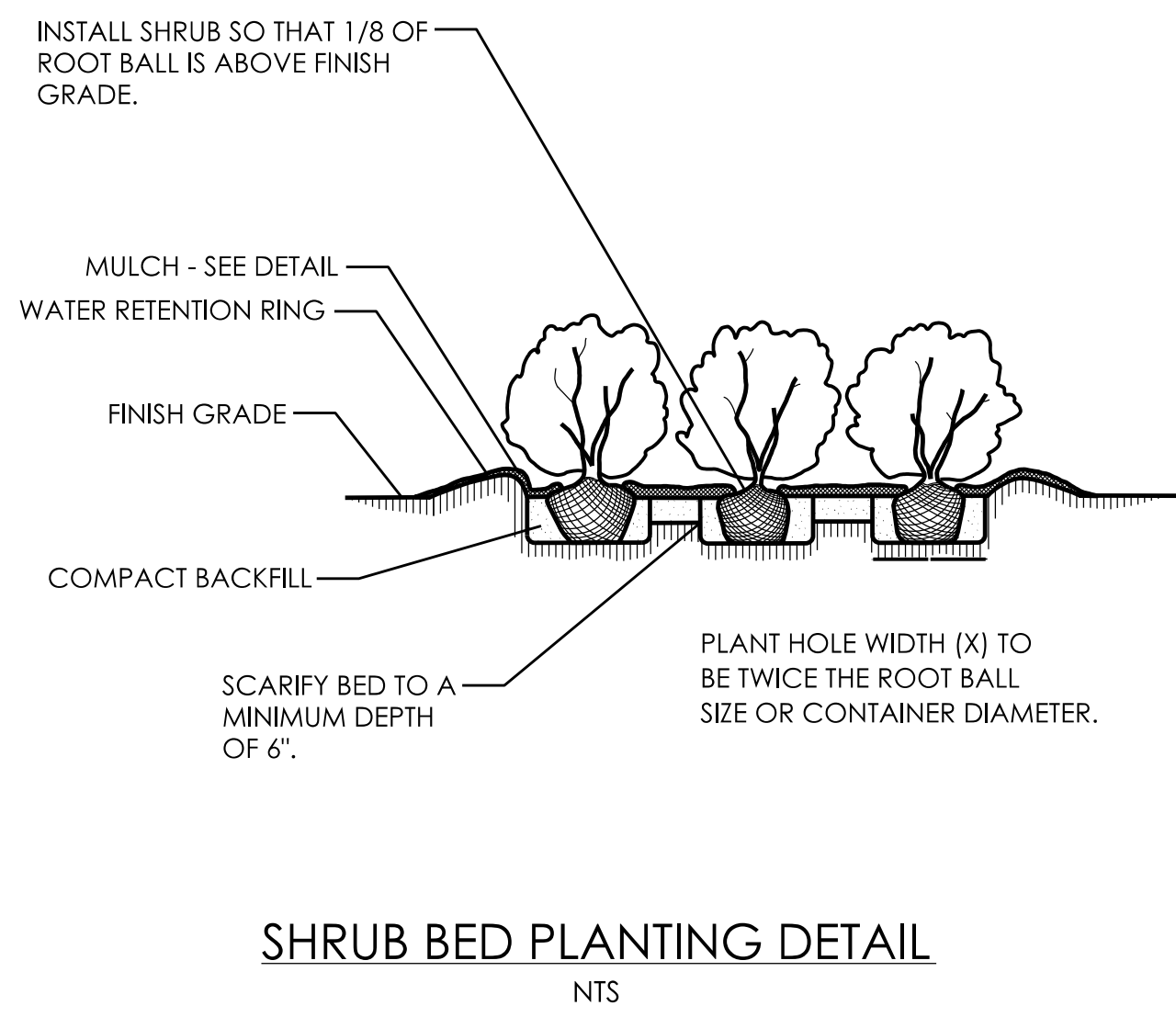
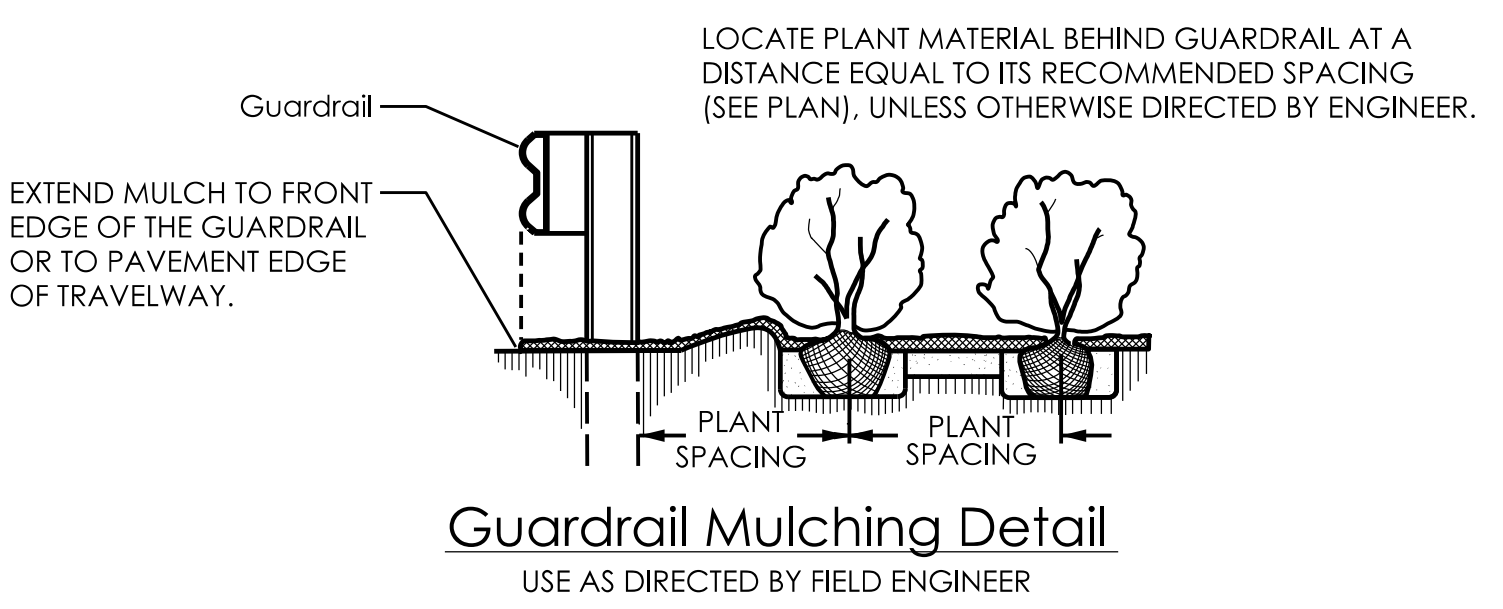
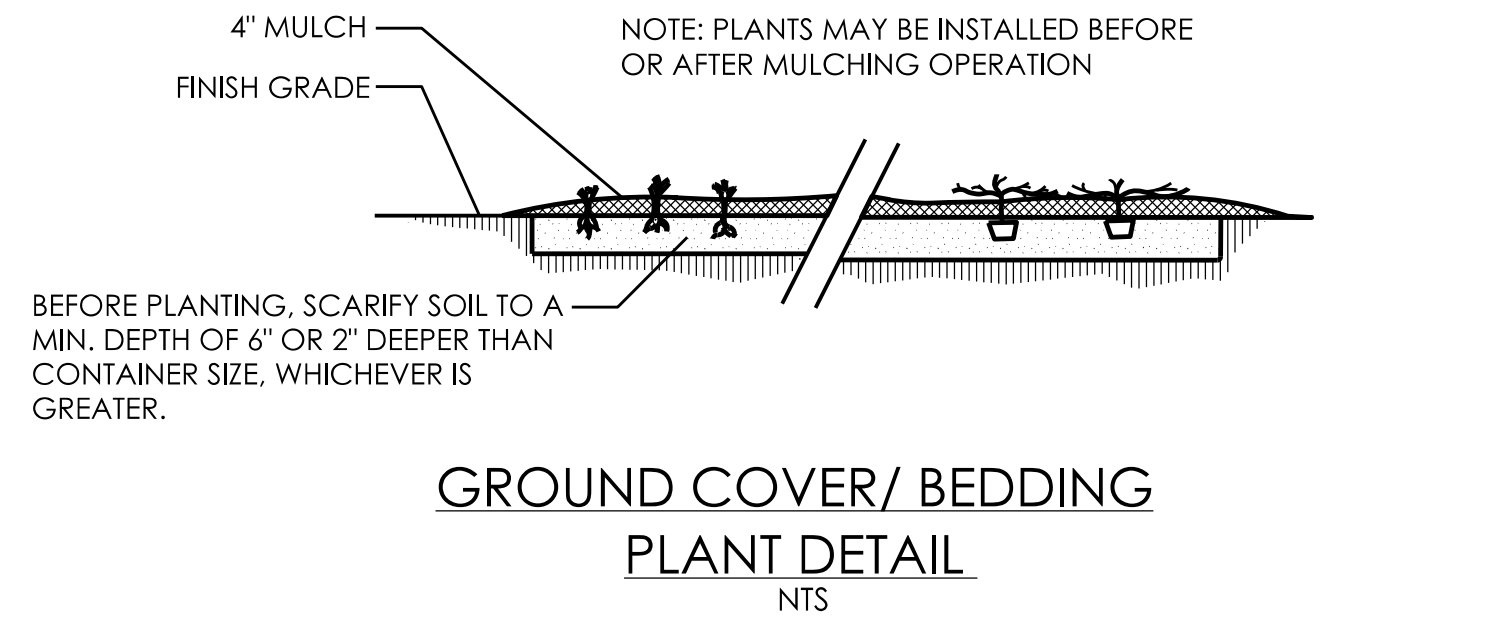

NCDOT - ROADSIDE ENVIRONMENTAL UNIT
 AESTHETIC ENGINEERING SECTION
 1557 MAIL SERVICE CENTER RALEIGH NC 27699-1557
 PH: 919-707-2935 FAX: 919-715-2554
http://www.ncdot.org/doh/operations/dp_chief_eng/roadside/

NC 102 & South Bypass in Ayden
 Pitt County
 TIP #: R-2250

Landscape Architect

SHEET DESCRIPTION:	PREL. DESIGN DATE:	Sept. 2019
	CHECKED BY & DATE:	-----
	FINAL DESIGN DATE:	Nov. 23, 2020

Planting Details
Landscape Plan Sheet

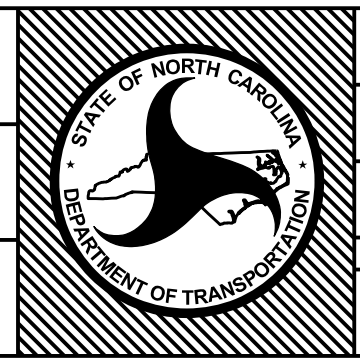

T.I.P. #	R-2250
WBS #	34411.1.2
FED I.D. #	-----
SHEET NO.:	L-2
TOTAL SHEET NO.:	L-5

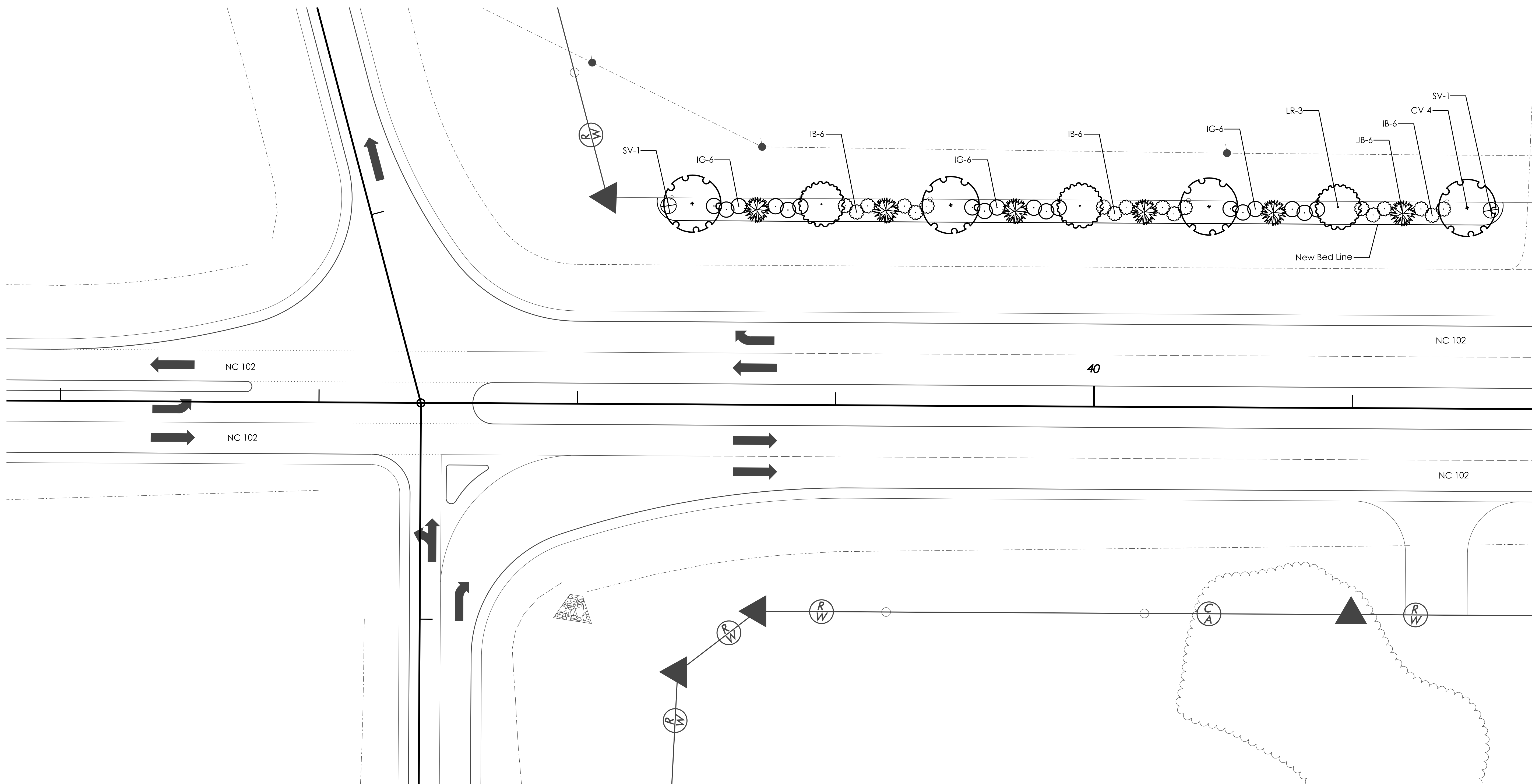

QTY	KEY	BOTANICAL NAME	COMMON NAME	SPACING
4	CV	<i>Chionanthus virginicus</i>	White Fringe Tree	50' O.C.
18	IB	<i>Ilex cornuta</i> 'Dwarf Burford'	Dwarf Burford Holly	5' O.C.
18	IG	<i>Ilex glabra</i>	Inkberry Holly	5' O.C.
6	JB	<i>Juniperus virginiana</i> 'Burkii'	Burk Eastern Red Cedar	AS Shown
3	LR	<i>Lagerstroemia indica</i> 'Whit IV'	Red Rocket Crape Myrtle	50' O.C.
2	SV	<i>Spiraea x vanhouttei</i>	Vanhoutte Spirea	AS Shown

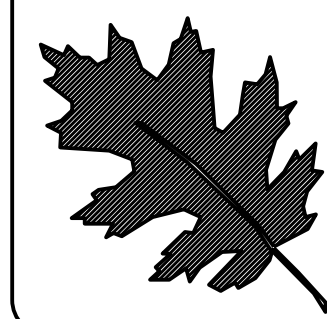

NCDOT - ROADSIDE ENVIRONMENTAL UNIT
 AESTHETIC ENGINEERING SECTION
 1557 MAIL SERVICE CENTER RALEIGH NC 27699-1557
 PH: 919-707-2935 FAX: 919-715-2554
http://www.ncdot.org/doh/operations/ap_chief_eng/roadside/

NC 102 & South Bypass in Ayden
 Pitt County
 TIP #: R-2250

Landscape Architect
 Kyle Coody

PREL. DESIGN DATE:	Sept. 2019
CHECKED BY & DATE:	-----
FINAL DESIGN DATE:	Nov. 23, 2020

Planting Plan
 Landscape Plan Sheet

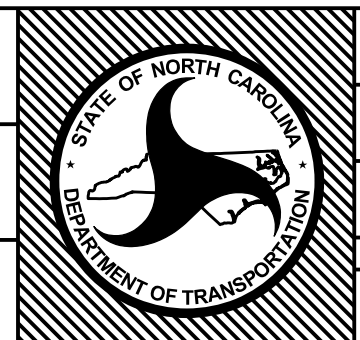

T.I.P. #	R-2250
WBS #	34411.1.2
FED I.D. #	-----
TOTAL SHEET NO.:	L-3 / L-5

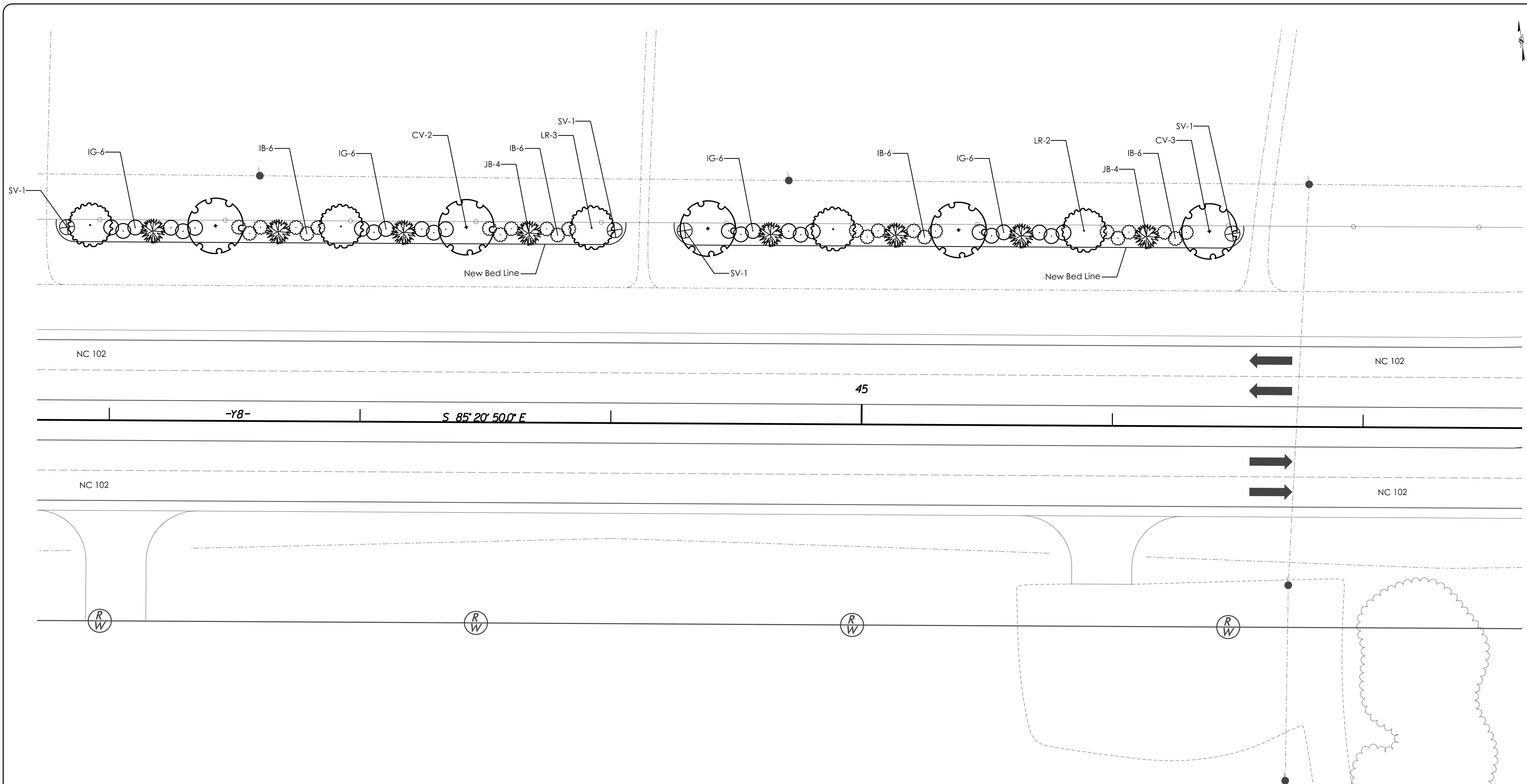

QTY	KEY	BOTANICAL NAME	COMMON NAME	SPACING
5	CV	<i>Chionanthus virginicus</i>	White Fringe Tree	50' O.C.
24	IB	<i>Ilex cornuta</i> 'Dwarf Burford'	Dwarf Burford Holly	5' O.C.
24	IG	<i>Ilex glabra</i>	Inkberry Holly	5' O.C.
8	JB	<i>Juniperus virginiana</i> 'Burkii'	Burk Eastern Red Cedar	AS Shown
5	LR	<i>Lagerstroemia indica</i> 'Whit IV'	Red Rocket Crape Myrtle	50' O.C.
4	SV	<i>Spiraea x vanhouttei</i>	Vanhoutte Spirea	AS Shown





NCDOT - ROADSIDE ENVIRONMENTAL UNIT
AESTHETIC ENGINEERING SECTION
 1557 MAIL SERVICE CENTER RALEIGH NC 27699-1557
 PH: 919-707-2935 FAX: 919-715-2554
http://www.ncdot.org/doh/operations/ap_chief_eng/roadside/

NC 102 & South Bypass in Ayden
Pitt County
 TIP #: R-2250

Landscape Architect

PREL. DESIGN DATE: Sept. 2019
 CHECKED BY & DATE: -----
 FINAL DESIGN DATE: Nov. 23, 2020

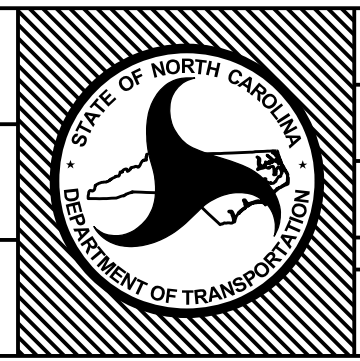
Planting Plan
 Landscape Plan Sheet



T.I.P. # R-2250
 WBS # 34411.1.2
 FED I.D. # -----
 TOTAL SHEET NO.:
L-4 **L-5**

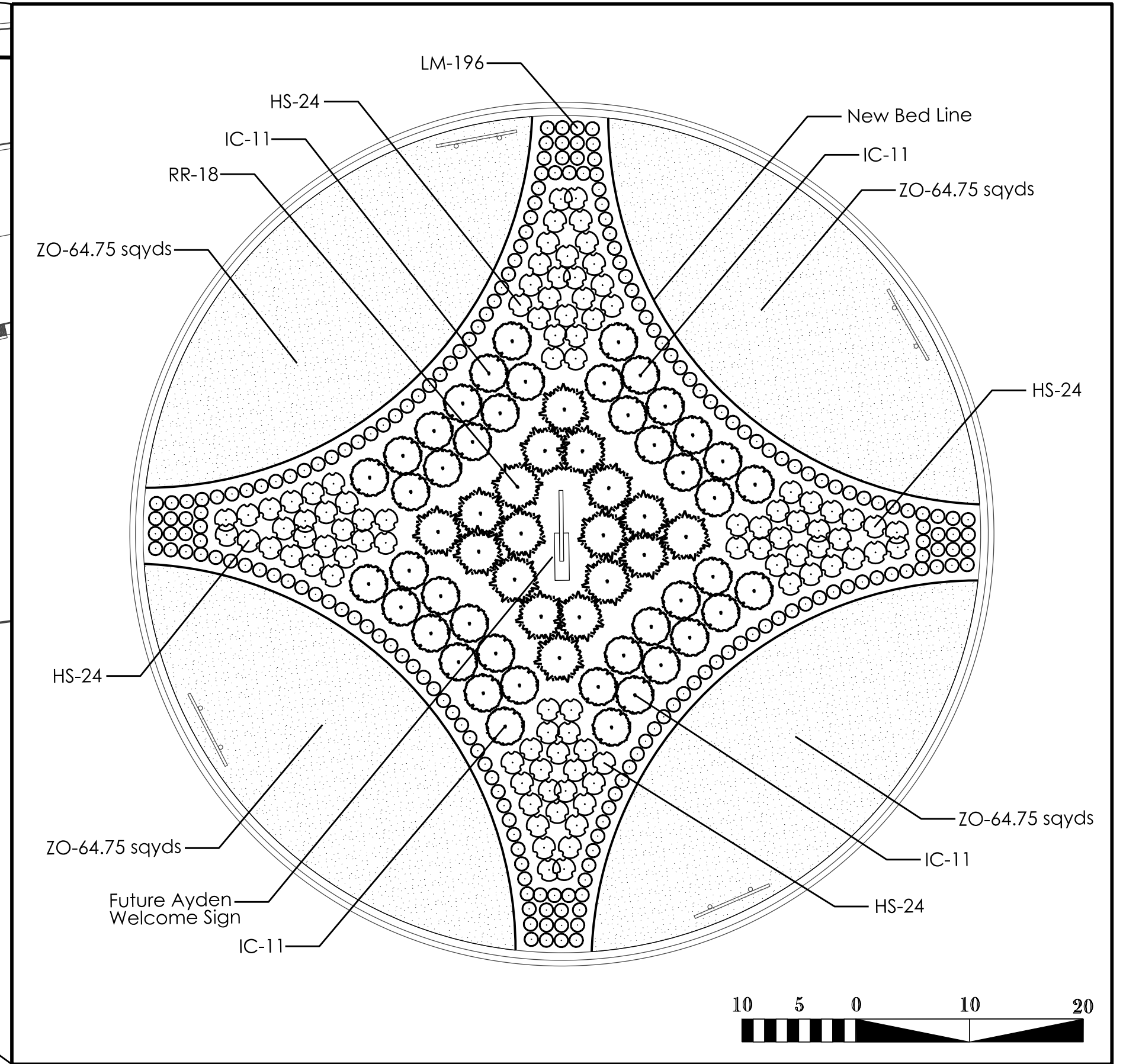
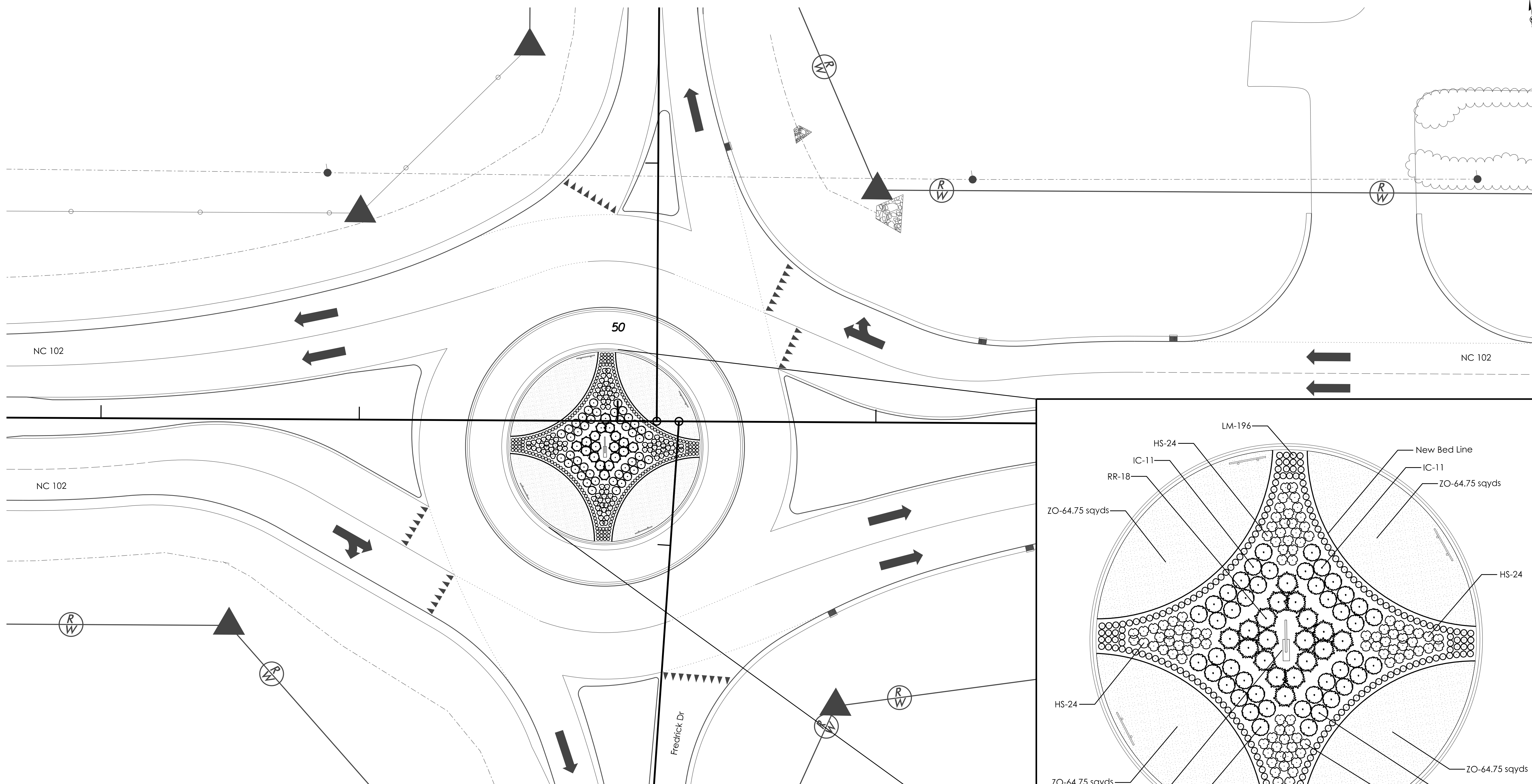

QTY	KEY	BOTANICAL NAME	COMMON NAME	SPACING
96	HS	<i>Hemerocallis 'Stella de Oro'</i>	Stella de Oro Daylily	2' O.C.
44	IC	<i>Ilex cornuta 'Carissa'</i>	Carissa Holly	3.5' O.C.
196	LM	<i>Liriope muscari 'Variegata'</i>	Variegated Lilyturf	16" O.C.
18	RR	<i>Rosa 'Radtko'</i>	The Double Knock Out® Rose	4' O.C.
259 sqyds	ZO	<i>Zoysia 'Zenith'</i>	Zenith® Zoysiagrass	Tight Seams

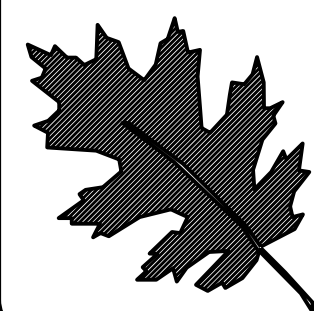

NCDOT - ROADSIDE ENVIRONMENTAL UNIT
 AESTHETIC ENGINEERING SECTION
 1557 MAIL SERVICE CENTER RALEIGH NC 27699-1557
 PH: 919-707-2935 FAX: 919-715-2554
http://www.ncdot.org/doh/operations/ap_chief_eng/roadside/

NC 102 & South Bypass in Ayden
 Pitt County
 TIP #: R-2250

Landscape Architect
 Kyle Cooney

SHEET DESCRIPTION:
 PREL. DESIGN DATE: Sept. 2019
 CHECKED BY & DATE: -----
 FINAL DESIGN DATE: Nov. 23, 2020

Planting Plan
 Landscape Plan Sheet

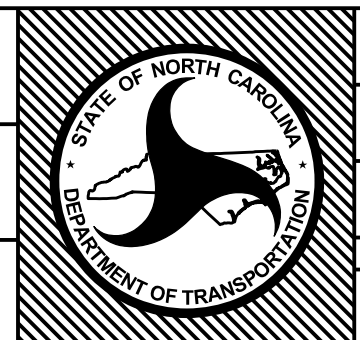

T.I.P. # R-2250
 WBS # 34411.1.2
 FED I.D. # -----
 TOTAL SHEET NO.:
 L-5 L-5